



No.	observe parameters of indoor and outdoor units	Normal State
1	Is there anything wrong with indoor units	None
2	Whether indoor unit blows air at normal air speed.	It blows out cool air at set air speed.
3	Whether there is abnormal noise in indoor and outdoor units	no abnormal noise
4	Whether ambient temperature, inlet temperature of coil pipe, midpoint temperature of coil pipe and outlet temperature of coil pipe of indoor units are normal	Within the allowable range of allowable error
5	Whether the electronic expansion valve of indoor unit is normal	Opening degree is available in case of startup. The EXV can be closed normally.
6	Whether there is anything wrong with outdoor units	None
7	Whether the frequency of compressor is normal	The compressor operates in automatic frequency
8	Whether the outdoor fan motor is normal.	The fan motor operates in automatic speed.
9	Whether temperature sensor of outdoor unit is normal	Within the range of allowable error

## 6. IDU Parameter setting by Controller

### 6.1 Parameter Setting Items

No.	Parameter Setting Items	Default value	Min. value	Max. value	Remark
1	communication address of indoor unit	1	1	64	
2	centralized address of indoor unit	1	1	64	
3	address of wired controller of indoor unit	1	1	16	
4	model of indoor unit	1	0	35	01 50HZ Low ESP Duct (Drain Pump) ; 01 Mid ESP Duct (Drain Pump) ; 02 High ESP Duct (Within 60K) 02 High ESP Duct (2 Pipe system,22.28.45.54kw) 10 Cassette Unit C7 Type (09-18K) ; 10 DC Cassette Unit E Type (09-18K) ; 11 DC Cassette Unit (24-48K , MB12) ; 12. DC Mid ESP Duct 13 : Ceiling & Floor Unit 22 Fresh Air Processor (2 Pipe system,22.28.45.54kw) 23- AHU 24 Mid ESP Duct ( Optional Drain Pump) 24 60HZ Low ESP Duct ( Drain Pump) 24 DC E type Low ESP Duct ( Drain Pump) 24 E type Low ESP Duct ( Optional Drain Pump ) 26 DC E type Low ESP Duct 28 One way cassette 30 Two way cassette 32 Wall - Mounted (L Type ) 34 Fresh Air Processor (1Pipe system,22.28kw) 35 High ESP Duct (1 Pipe system,22.28kw)
5	capacity of indoor unit	8	1	100	280W/unit
6	priority of indoor unit	0	0	3	0--No priority 1--priority 1 2--priority 2 3--priority 3
7	heating temperature compensation of indoor unit	0	0	10	Unit:°C
8	auto restart function of indoor unit	1	0	1	0—Available 1--not available
9	room card selection	0	0	1	0--invalid room card

					1--valid room card
10	clearing time of filter net	5	1	5	500h/unit
11	operating mode displayed by wired controller	1	0	2	0--[auto][heating] [dehumidification][cooling][ventilation] 1--[heating] [dehumidification][cooling][ventilation] 2--[dehumidification][cooling][ventilation]
12	installation height of indoor unit	0	0	1	0-- installation height is lower than 2.7m 1--installation height is higher than 2.7m
13	switching between Celsius degree and Fahrenheit	0	0	1	0--Celsius degree 1--Fahrenheit
14	display of room temperature	0	0	1	0-- room temperature not to be displayed 1-- room temperature to be displayed
15	selection of room temperature	0	0	1	0-- temperature sensor of return air 1--temperature sensor of wired controller

## 6.2 Parameter setting by YK – L

### 6.2.1 Enter the setting interface

- ① Make sure the remote controller is off
- ② Press the two white button at the down side simultaneously more than 10s to enter the address setting mode.
- ③ First, will display "1" , "1" ,
- ④ the above number means : series parameter number ,from 1~15
- ⑤ the below number means : Meaning of parameter correspondence

#### For example :

Check "6.1 Parameter Setting Items" for number of parameters and corresponding meaning.

"1" , "1" , the indoor unit's address is 1#

"4" , "32" , the indoor unit's type is Wall - Mounted (L Type )

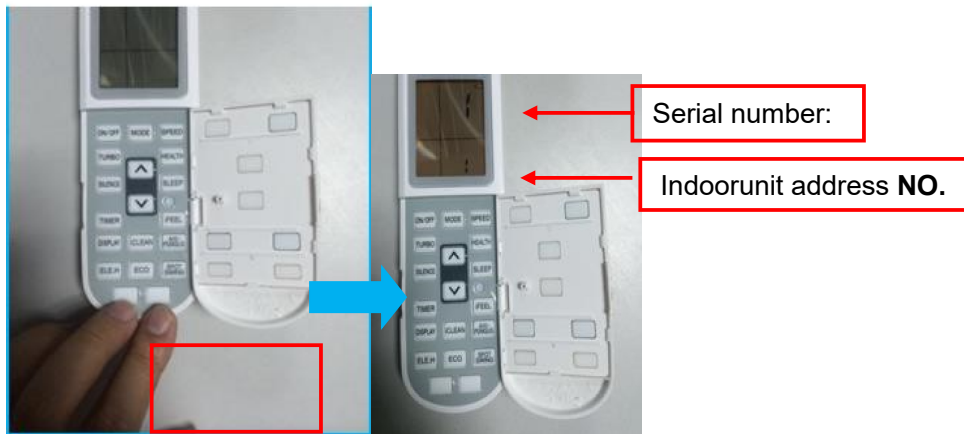

### 6.2.2Parameter Setting

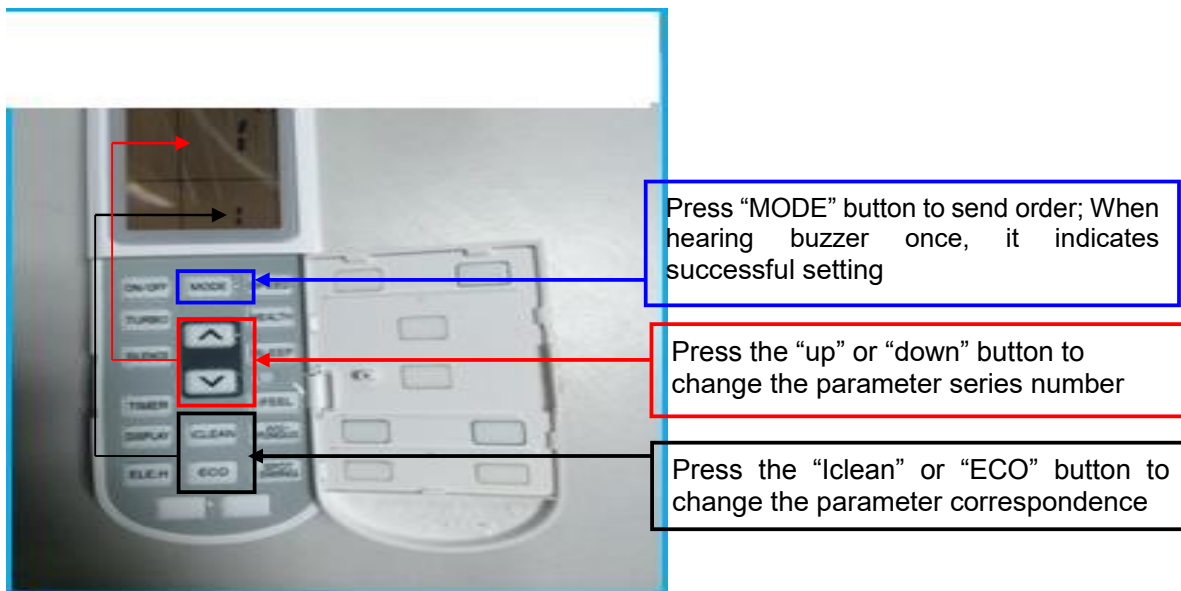

### 6.3 Parameter setting by XK-02A

#### 6.3.1 Enter the setting interface

① Press [Filter Net Button] for 5 seconds, group number “01” of wired controller will be displayed in temperature zone of LCD screen and “0101” will be displayed in timing setting zone of LCD screen.

② “01” means that group number of wired controller is 1; “0101” means this indoor unit address is No. 1 .

③ Press [+/- Button of Time], “0201”, “0301”, “0401” “0510” will be displayed successively. Check “6.1 Parameter Setting Items” for number of parameters and corresponding meaning.

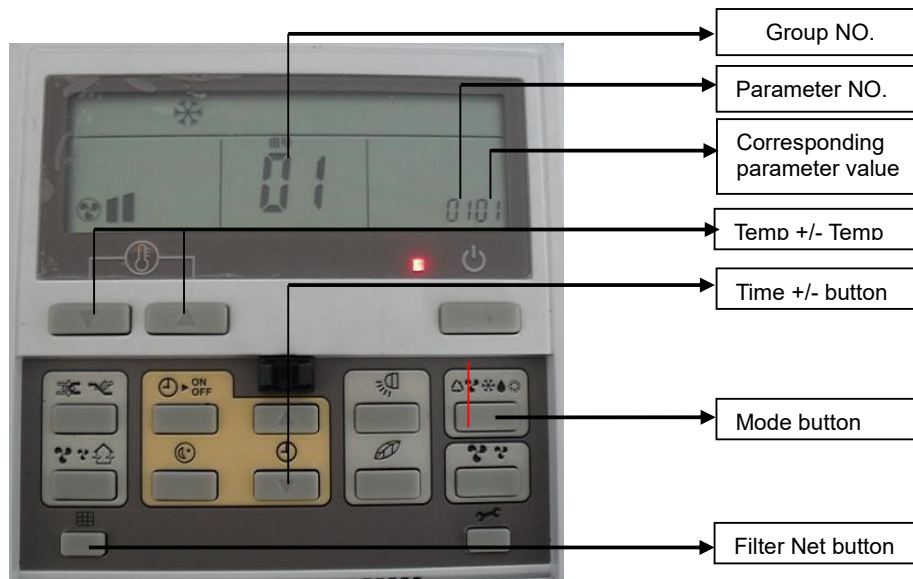

#### 6.3.2 Parameter Setting

Go on with previous interface and change No. 1 indoor unit into No. 5 indoor unit:

① Press [Filter Net Button] for 5 seconds, group number “01” of wired controller will be displayed in temperature zone of LCD screen and “0101” will be displayed in timing setting zone of LCD screen as shown in previous interface.

② Then press [Mode Button] once, “corresponding parameter value 01” will flicker; press [+/--button of time] again to change the value into “05”, press [Mode Button] to confirm. This indoor unit address is changed as No. 5.

## 6.4 Parameter setting by XK-05A

### 6.4.1 Enter the setting interface

- ① Press “Function” button for 10 s to enter the setting interface.
- ② “0303” means address of wired controller of indoor unit. Check “**6.1 Parameter Setting Items**” for number of parameters and corresponding meaning.

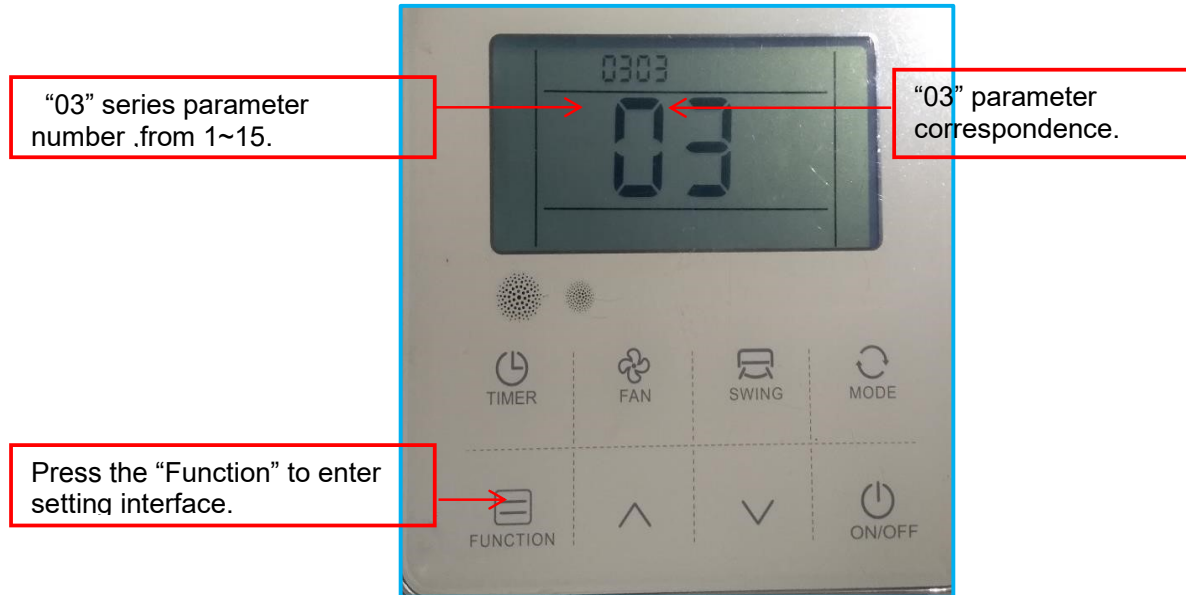

### 6.4.2 change series parameter number

① Press “up” / “down” button to change the number.

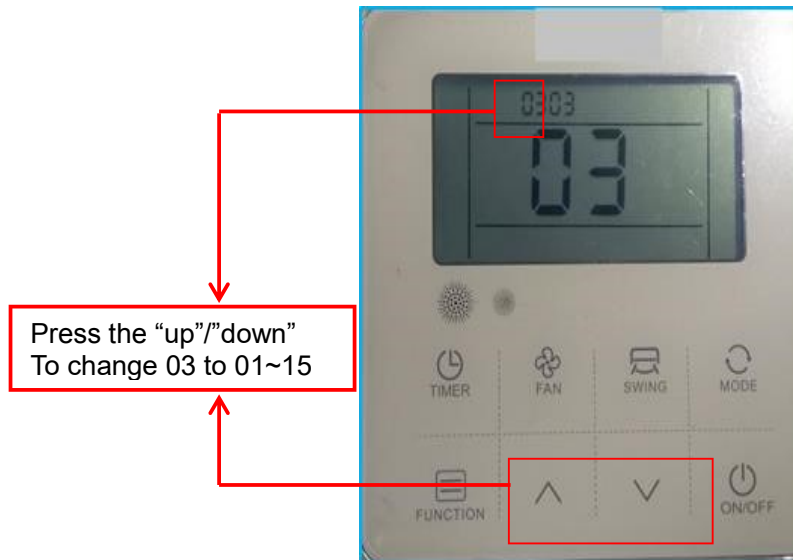

### 6.4.3 parameter correspondence setting.

① Press “Function” button , the second “03” will flash.

② Press “up” / “down” button to change the number.

